



# Phase One Feasibility Study Analysis and Space Needs Assessment for a Joint Public Safety Facility Expansion Project

---

PUBLIC SAFETY & TRANSPORTATION COMMITTEE

NOVEMBER 2, 2022





# Current Facilities

---

Police



Fire



# Project Overview

---

Included in the 2022 CIP are funds firm to conduct a feasibility study with a space needs analysis that evaluates current and future needs of the Lombard Police Department and Fire Department Administration Headquarters.

The purpose of the study is to define the current conditions and anticipated needs of both departments and the assessment of the practicality for options for both departments.

These facilities were constructed in the mid 1970's and were designed at a time when both the population of the Village and number of personnel for each department were significantly less than today.

As a result, each facility is not able to meet the current demands of the departments.

# Feasibility Study Analysis and Space Needs Assessment Scope

---

Facilities constructed in 1970s and do not meet current needs

Staffing levels and equipment are significantly larger than at the time of original construction

- Staffing
  - Police – 78 personnel
  - Fire – 73.5 personnel

The Village has conducted several studies to determine the appropriate space needs and functionality of the aging facilities.

The current assessment will be the roadmap to the improvements to the facilities, but what has been done to date...

# Previous Assessments & Findings

## 2008 Facility Needs Assessment (*PSA Dewberry*)

- Police Department
  - Current square footage = 23,400
  - 2030 Proposed Square footage = 58,553
- Fire Department
  - Fire Station #1 (Station 45)
    - Current square footage = 15,449
    - 2030 Proposed Square footage = 25,554
  - Fire Station #2 (Station 44)
    - Current square footage = 9,110
    - 2030 Proposed Square footage = 18,602

**TOTAL DEFICIENCIES = 54,750 SQUARE FEET**

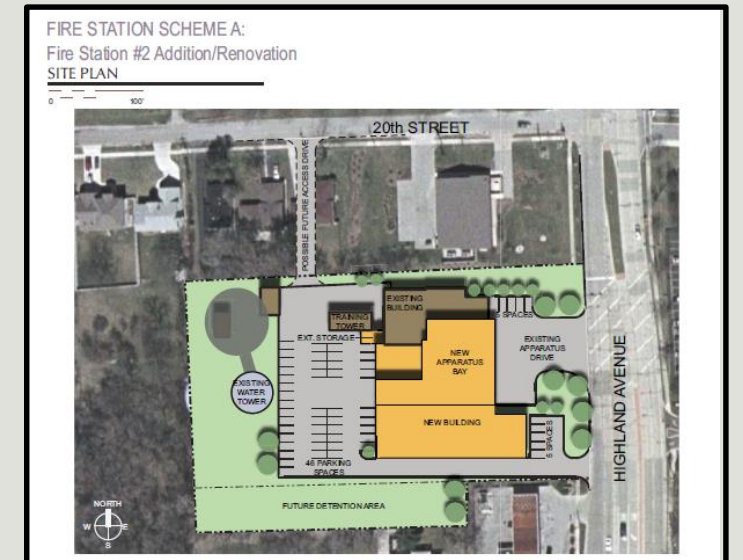
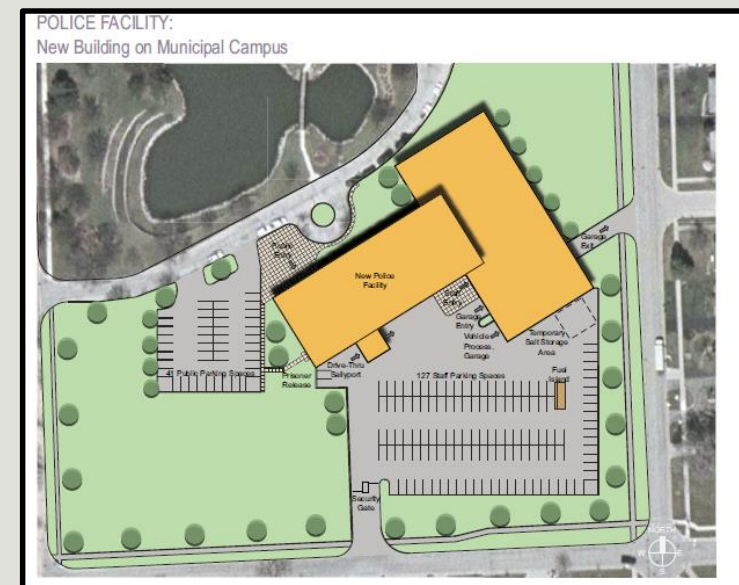

# Previous Assessments & Findings

2021 Fire Station 45 Space Needs Assessment (TRIA Architecture) proposed the following improvements:

- Renovation of 3,452 square feet
- Constructing an addition of 1,103 square feet

Addressed the following issues:

- Additional washroom on 1<sup>st</sup> floor (women's)
- Lt. Office expansion
- Bunk room privacy improvements
- Second floor ADA
- Locker room expansion
- Modernize façade of building

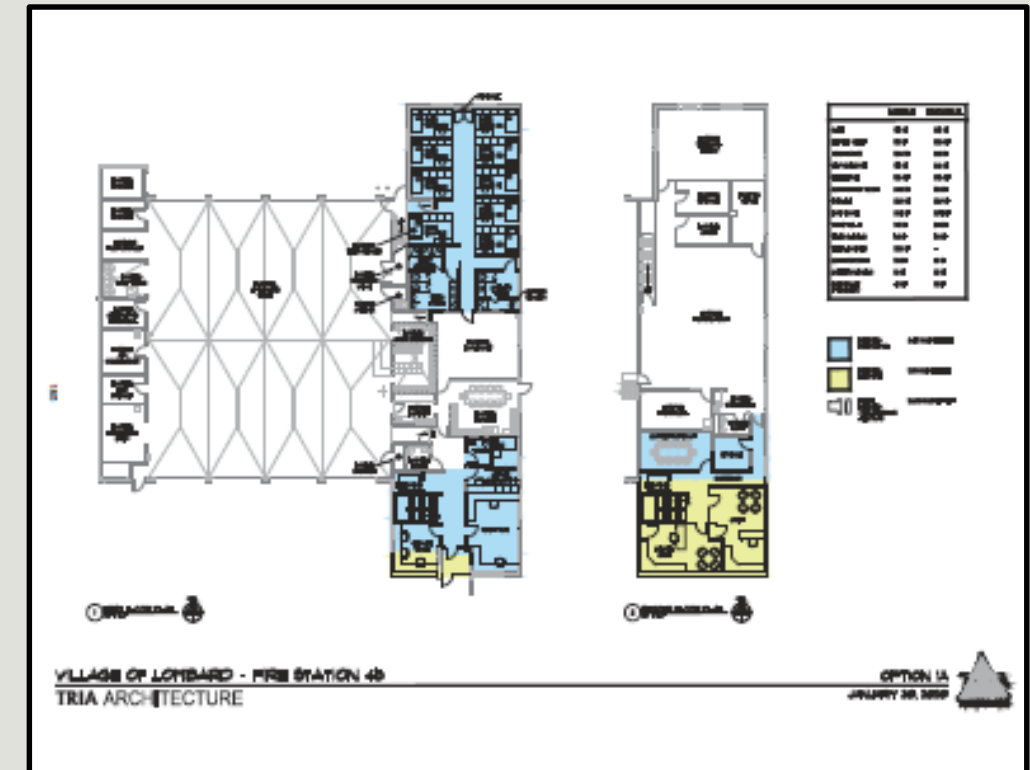

# Addressing Operational Deficiencies

Since the time the Station 45 analysis was completed, the Village has determined that there is an operational deficiency in the response time to the central portion of the community and wishes to address this service level as part of the facility improvement program.

The FD's stated goal is to respond to calls within 4 minutes

Due to the location of Stations 44 and 45, there is a "gap" in response time as depicted in the image to the right

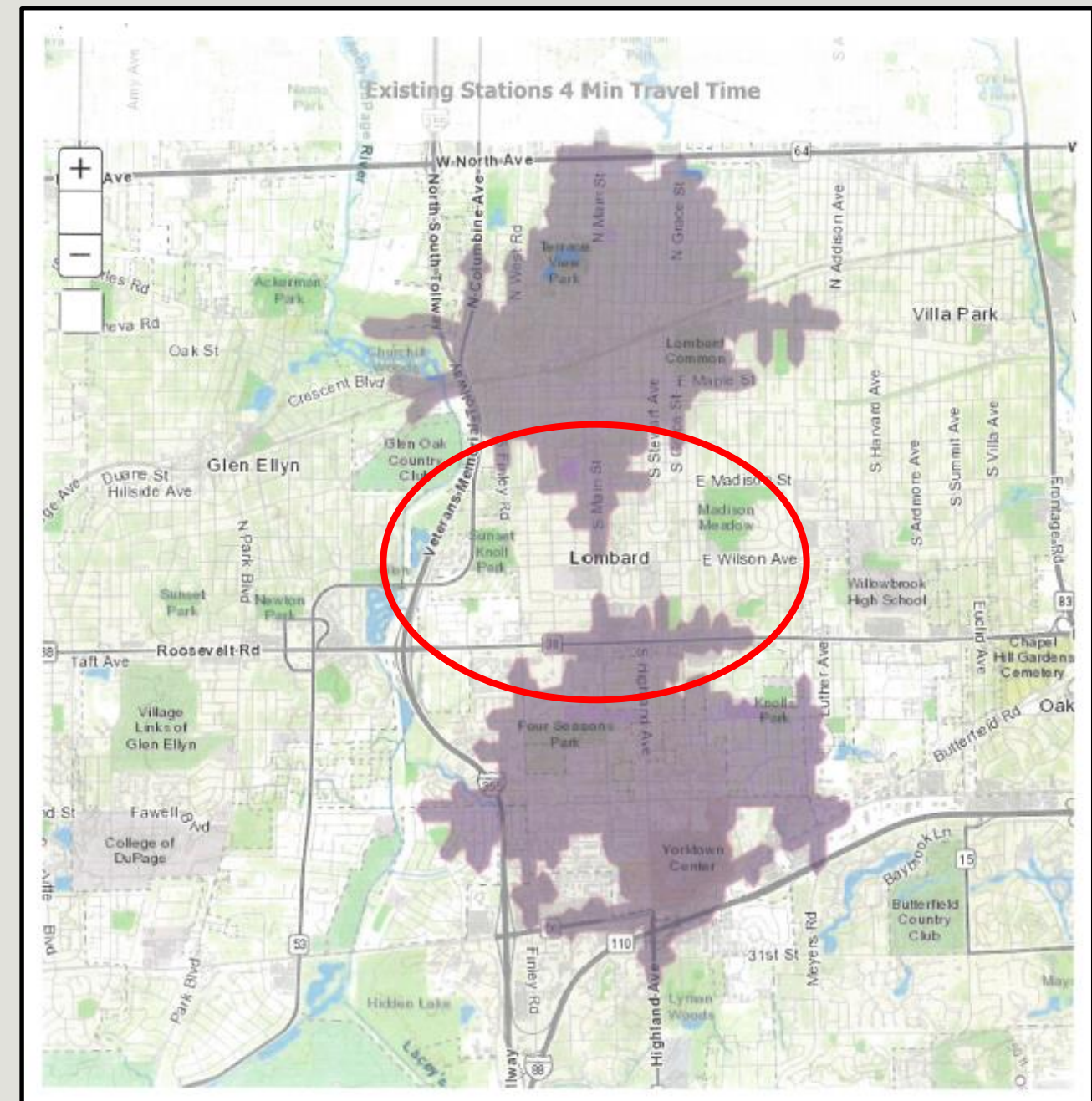



# FGMA Evaluation

The study has focused on providing an evaluation for three (3) projects, which build off of each other. The concepts being explored from a space needs, as well as budgetary perspective include the following:

1. Police and Fire Admin on the municipal campus
2. Police, Fire Admin, and the Central Fire Station on the municipal campus
3. Stand Alone Central Fire Station

Based upon the efforts of FGMA, it has been determined that the Village Complex is not large enough to accommodate the enlarged police facility and a fire facility to address the coverage issues.

**TOO MUCH STUFF!!!**



# Where does this leave the Village?

---



- Expansion of Police Department to incorporate needs, including training facility to accommodate Fire Department
- Evaluate sites for construction of a free standing Central Fire Station
- Evaluate alternative service delivery for Fire Department to address response time



# LOMBARD PSB FEASIBILITY STUDY

255 E WILSON AVE, LOMBARD ILLINOIS 60148

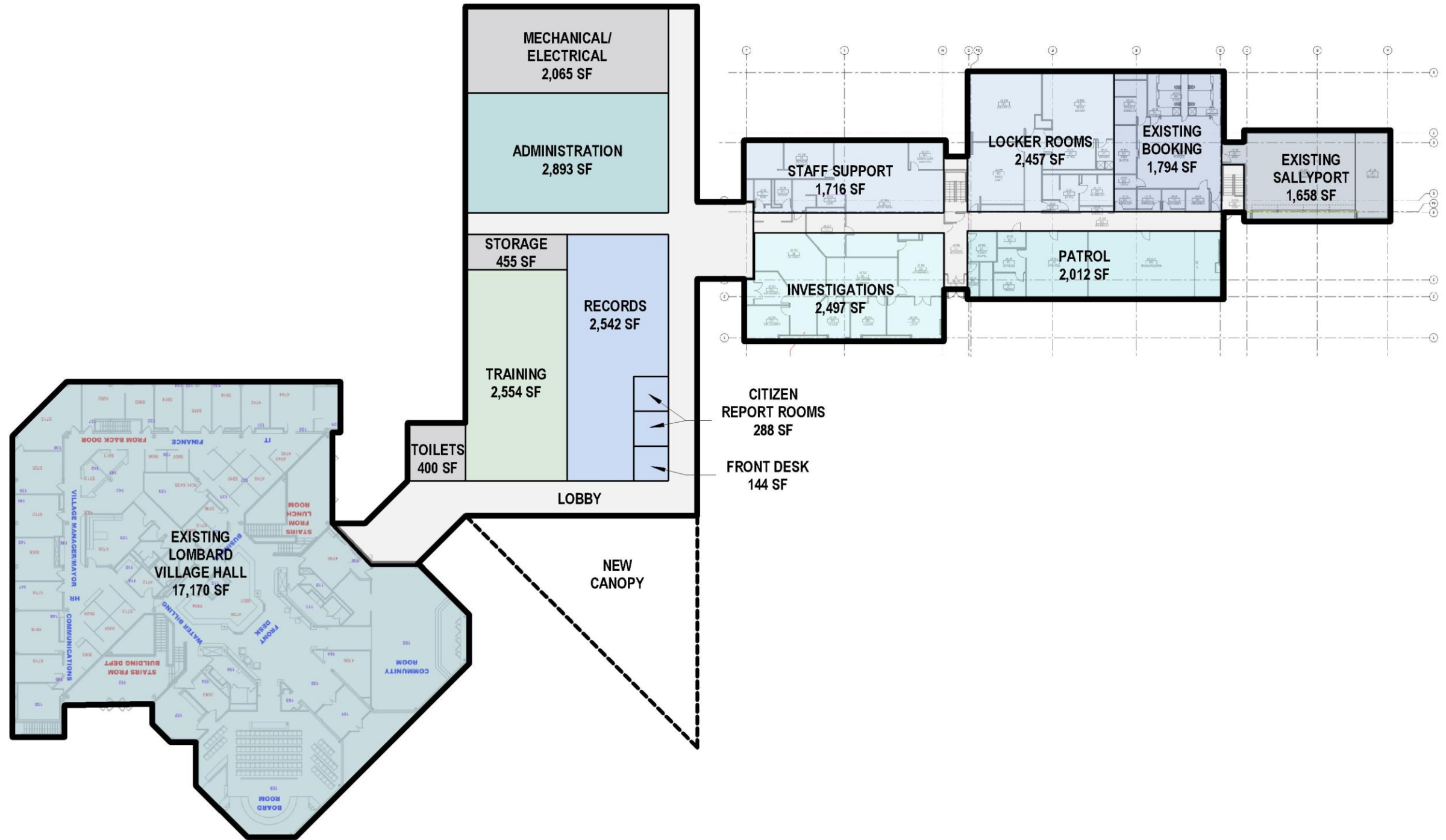

## VH/POLICE PLAN DIAGRAM

VILLAGE OF LOMBARD  
Job No. 22-3439.01

Published 08/24/22  
©2022 FGM Architects Inc.

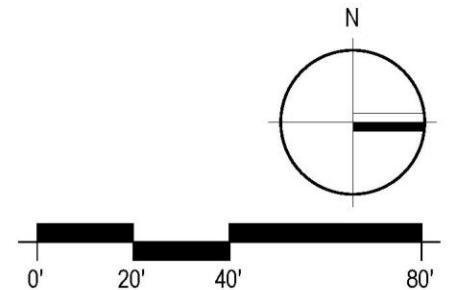

# LOMBARD PSB FEASIBILITY STUDY

255 E WILSON AVE, LOMBARD ILLINOIS 60148

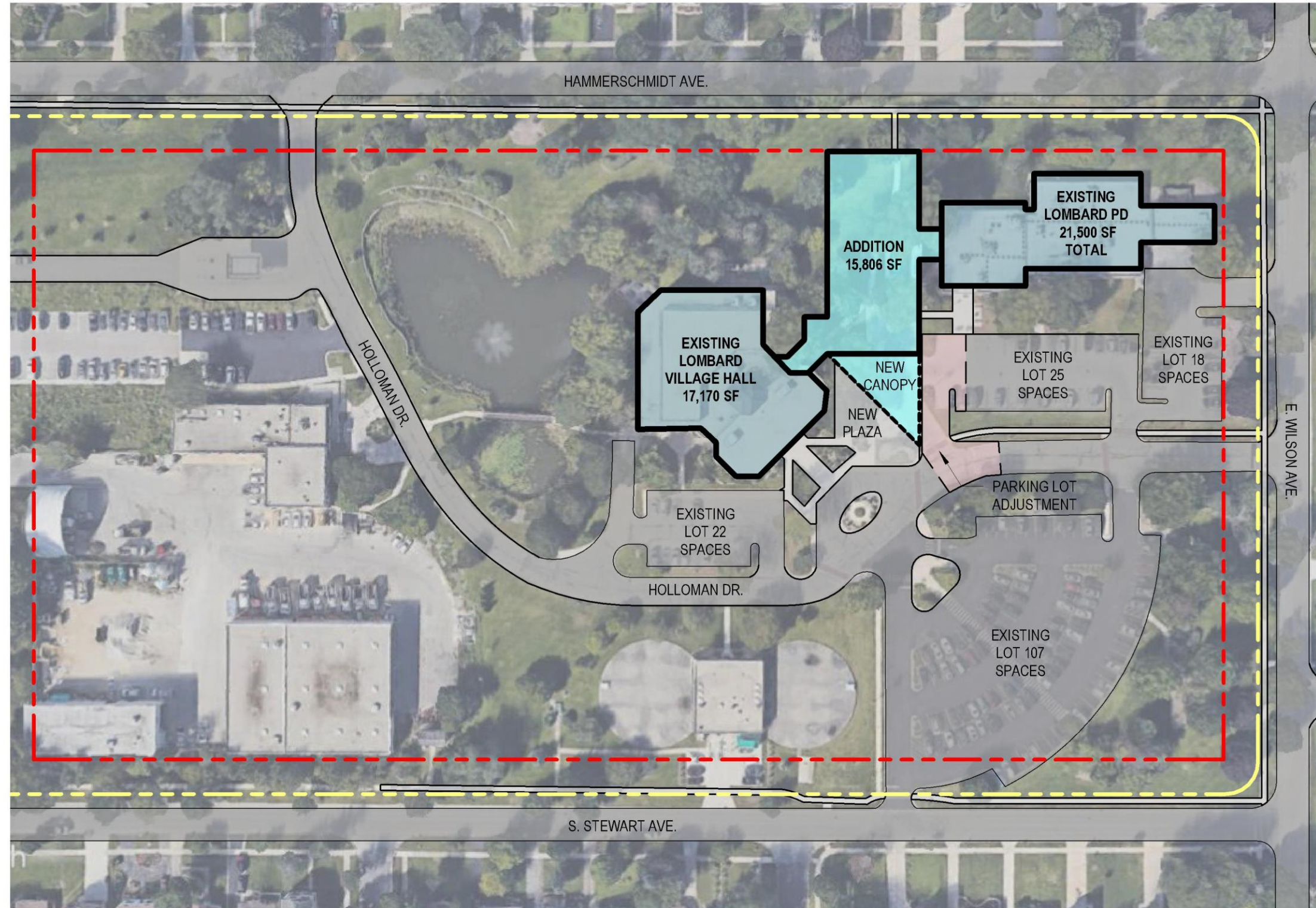

## VH/POLICE SITE DIAGRAM

VILLAGE OF LOMBARD  
Job No. 22-3439.01

Published 08/24/22  
©2022 FGM Architects Inc.

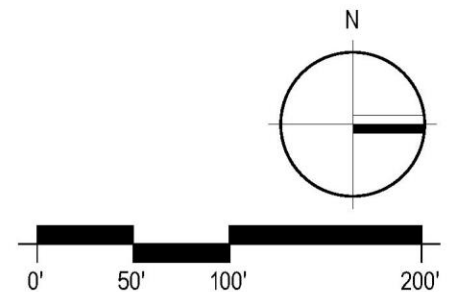

# LOMBARD CENTRAL FIRE STATION STUDY

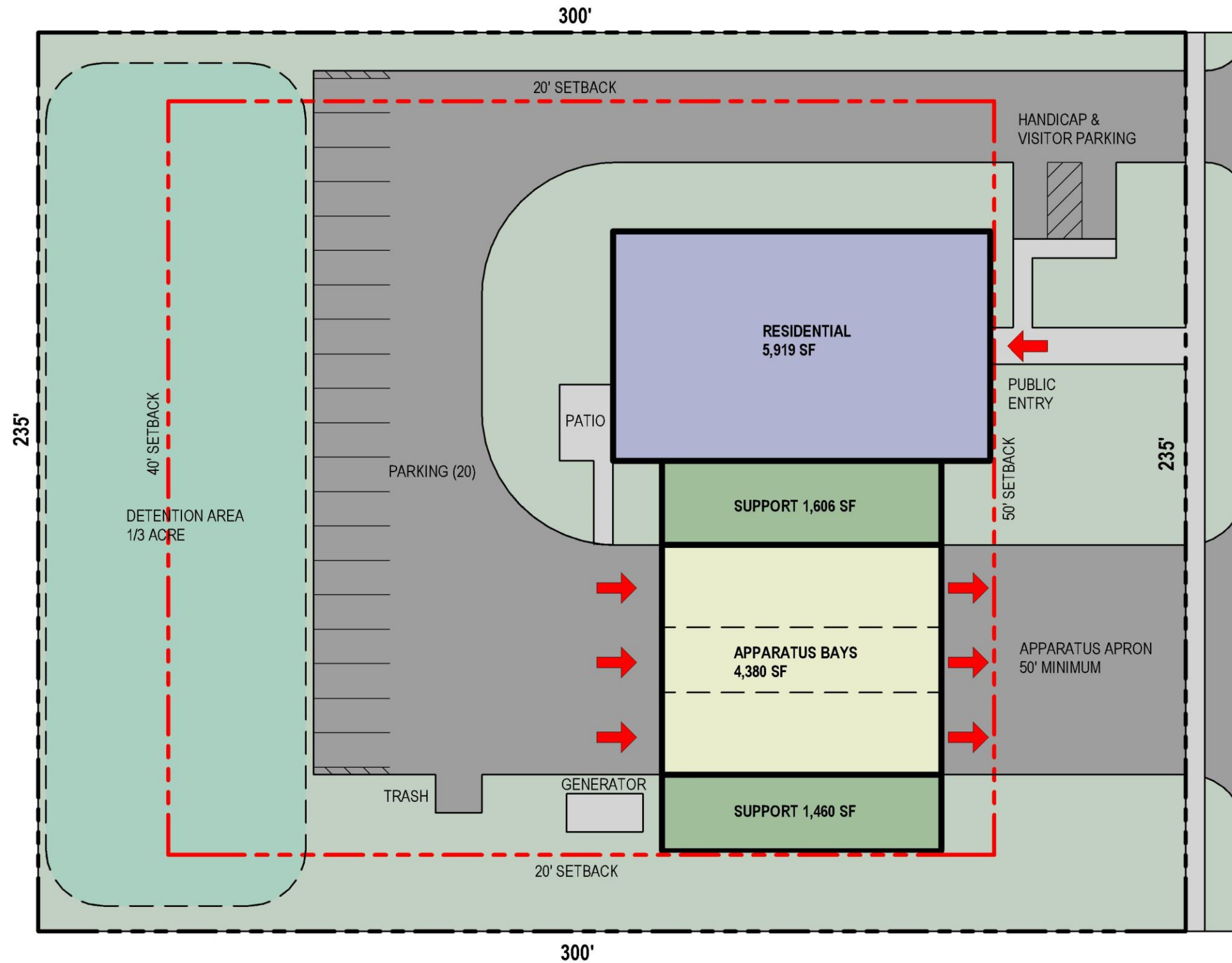

|                          |             |
|--------------------------|-------------|
| MINIMUM SITE REQUIREMENT |             |
| TOTAL AREA               | 70,500 SQFT |
| TOTAL ACREAGE            | 1.6 ACRES   |



## SITE PLAN DIAGRAM - IDEAL

# LOMBARD CENTRAL FIRE STATION STUDY

541 E MADISON ST, LOMBARD ILLINOIS 60148

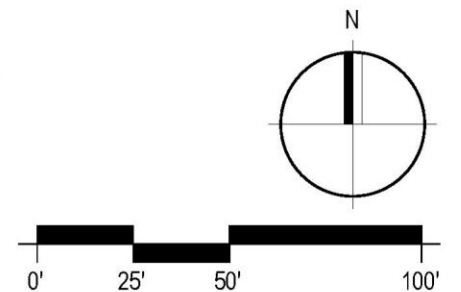

## MADISON MEADOWS SITE

VILLAGE OF LOMBARD  
Job No. 22-3439.01

Published 08/24/22  
©2022 FGM Architects Inc.



# LOMBARD CENTRAL FIRE STATION STUDY

1180 S FAIRFIELD AVE, LOMBARD ILLINOIS 60148

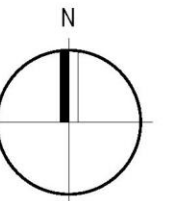

## FAIRFIELD AVENUE SITE

VILLAGE OF LOMBARD  
Job No. 22-3439.01

Published 08/24/22  
©2022 FGM Architects Inc.



Amy

Questions