



October 1, 2018

TO: Public Works and Environmental Concerns Committee

FROM: Carl Goldsmith, Director of Public Works *ag*

SUBJECT: Request for Variation – Backyard Drainage Grant

The Village of Lombard created the Backyard Drainage Grant program with the intent to eliminate flood-prone backyards through cooperative efforts by the Village of Lombard and effected residents. The program is created, and exists, through a Village Policy (4.D.). The program is jointly administered by the Public Works Department and the Community Development Department. The program is funded through the Water and Sewer Capital Fund at a level of \$20,000 annually.

Like all grant programs created by a Village Board Policy, the Backyard Drainage Grant program has established eligibility requirements and procedures that assist staff in administering the grant programs. A copy of the program guidelines are attached for your consideration and review. A summary of the criteria can be found below:

- The program requires that two or more contiguous properties are directly affected by backyard flooding and experience standing water for more than 72 hours following a storm event.
- Eligible costs may include surveying, engineering, permits, and construction work and restoration.
- Drainage systems must include an appropriate restrictor.
- After passage of final inspections, the Village will reimburse the applicants for 50% of the project costs up to a maximum of \$5,000.
- "Direct" or "indirect" connections to combined and sanitary sewer systems are prohibited by current Village ordinance and will not be eligible for the grant program.
- Improvements constructed on private property will be operated and maintained by the property owners.

The Village has been in discussions with the property owners in the 100 blocks of S. Chase and Highland on flooding and stormwater issues for many years. The property owners have held multiple meetings with Village staff and elected officials on possible solutions to address their concerns relative to the stormwater and flooding issues. The Village included the construction of a manhole at 750 E. Maple in the Gatz Pond Outfall Project that would allow for the connection of the private storm sewer to the Village's storm sewer system.

Through the course of working with the neighborhood group, it was determined that easements would be needed from a property owner(s) with frontage to Maple in order to route the private storm sewer from the depressional area and make the connection to the sewer. Easements were not available from either 750 or 754 E. Maple. The group, with significant input from Village staff, has developed a plan to route a private storm sewer in the rear yards of four (4) properties along S. Chase Avenue and make the connection in the parkway on the north side of Maple. The group has demonstrated that they have been granted the easements and that the plats will be amended to include a ten (10) foot drainage easement.

Due to the scope of the project and the need to directionally drill the private storm sewer, the estimate of the project, is \$30,000. John Erl, 125 S. Chase, on behalf of twelve (12) affected property owners has submitted a request for a deviation from the guidelines established by the Backyard Drainage Grant Policy. The residents are requesting that the Village grant a waiver from the requirements of the Backyard Drainage Grant Program. The requested deviation from the policy is as follows:

- A variation from Section II.F., which establishes the maximum amount of reimbursement at \$5,000 per project. The residents are seeking a 50% reimbursement for the estimated \$30,000 project for a total reimbursement of \$15,000.

Staff has reviewed the submitted material from the property owner/applicant. Please note that no formal application has been made to date. The request for additional funding has been submitted prior to the Village approving plans for the project. The Village established the Backyard Drainage Grant Program in December 1999. Since the establishment of the program, there have been fifty-three (53) grant applications funded by the Village. In each case, there were two or more properties that benefited and in each case, the maximum reimbursement was capped at \$5,000 per the policy. The policy was developed and is implemented in a manner to preserve consistency and equality.

In 2013, the Village staff and elected officials conducted a meeting with this neighborhood group and committed to provide additional funds towards a project due to the number of impacted properties. The attached map identifies the properties that would see direct benefit of the project. Given the policy requirement that any grant include a minimum of two (2) properties and a maximum of \$5,000 is available for a minimum of two benefiting properties, staff would support the higher funding threshold.

This matter is being presented to the Committee for their review and recommendation for any deviations to the Village Board Policy. Given the information presented by the pending applicant, staff would recommend the requested deviation in the funding level from the grant program. The residents have presented information or material that identifies a unique set of circumstances that would warrant such steps being taken by the Village.



VILLAGE OF LOMBARD

255 E. Wilson Ave.
Lombard, Illinois 60148-3926
(630) 620-5700 Fax (630) 620-8222
www.villageoflombard.org

September 13, 2018

Village President
Keith T. Giagnorio

Village Clerk
Sharon Kuderna

Trustees

Dan Whittington, Dist. 1
Michael A. Fugiel, Dist. 2
Reid Foltyniewicz, Dist. 3
Bill T. Johnston, Dist. 4
Robyn Pike, Dist. 5
William "Bill" Ware, Dist. 6

Village Manager
Scott R. Niehaus

"Our shared Vision for Lombard is a community of excellence exemplified by its government working together with residents and businesses to create a distinctive sense of spirit and an outstanding quality of life."

"The Mission of the Village of Lombard is to provide superior and responsive governmental services to the people of Lombard."

Mr. John Erl
125 S. Chase Lane
Lombard, IL 60148

RE: Private Property Drainage Options for 100 blocks of S. Chase/Highland

Dear John:

As a follow-up to the meeting of September 5, 2018, staff has reviewed the proposed routing of the private storm sewer that was discussed at the meeting. "Option #5" that was proposed would place the private storm sewer in the rear yards of the homes located at 129 S. Chase, 133 S. Chase, 137 S. Chase and 740 E. Maple in dedicated drainage easements. The responsibility for the maintenance of the pipe within the easement would lie with the property owner of the property where the pipe is located.

Staff conducted a site visit on Thursday, September 6, 2018 to assess the proposed improvement. A synopsis of the findings and preliminary design can be found below.

Project Goals:

Primarily to eliminate the prolonged backyard flooding. Also, to infiltrate groundwater to help relieve the nonstop running of sump pumps. Therefore, a drain that is deeper than basements would reduce sump pump running and also be protected from blockage and movement due to freezing.

Project Design:

The entire 220' length will be directionally bored 8" diameter HDPE or PVC pipe. The terminus will be in the backyard of 129 S Chase, where a small non-functional HDPE inlet is currently located. The roughly 20'x6' push pit may easily be accommodated backyard. The roughly 8'x8' receiving pit will be in the side yard /sidewalk of 740 E Maple. There will be three concrete 48" catch basins, whose lift plugs shall not be sealed but wrapped with geotextile. Three perforated 6" diameter clean-out risers installed as vac-a-tees will be placed at property lines to allow infiltration and maintenance access. The sidewalk removal/replacement will be 45' long. Along the route are utility poles, low-hanging wires, fences, sheds and garages to avoid. A 5'-wide drainage & utility easement (also to accommodate the existing utility lines) will be required along the rear lot lines of the 4 properties. It is understood that there are no underground utilities in conflict with the proposed drain. Following construction, the Village will accept ownership and maintenance responsibility of only the portion of the storm sewer located within the public right-of-way. Trenching along this route is not deemed viable due to proximity of structures, utility poles, and low overhead wires.

Cost Estimate:

\$30,000 (note that directional boring costs are typically higher than trenching, and they fluctuate greatly)

Proposed Storm Sewer Route



Proposed Connection Elevations

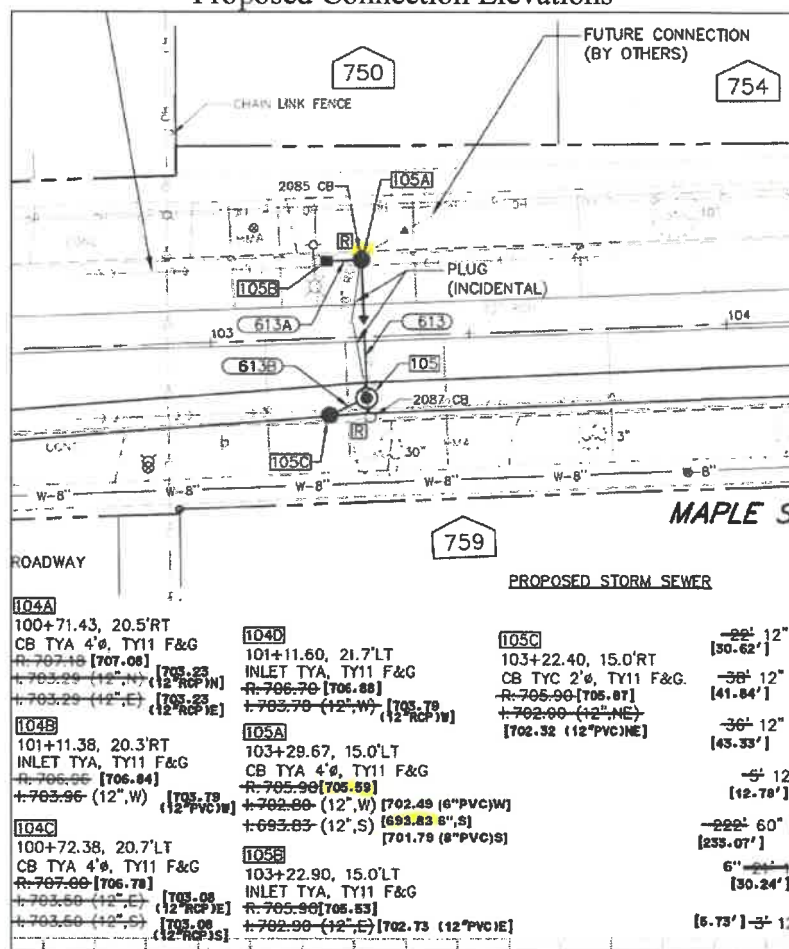

Proposed Storm Sewer Profile

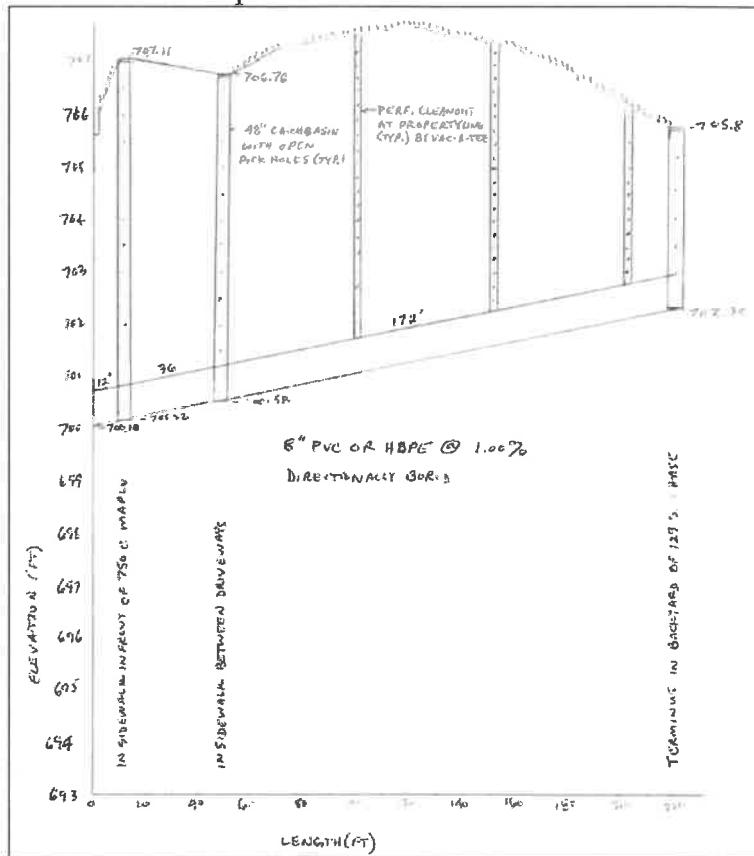

Once you determine whether the four (4) property owners would be willing to grant the proper drainage easements, I will bring the issue of the grant funding to the Public Works and Environmental Concerns Committee for consideration. Should you have any questions please feel free to contact me.

Sincerely,

Carl Goldsmith
Director of Public Works

cc: Trustee Robyn Pike, District #5
Trustee Bill Ware, District #6
Scott Niehaus, Village Manager
Anthony Invergo, 129 S. Chase

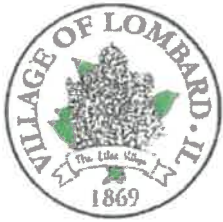

VILLAGE OF LOMBARD

255 E. Wilson Ave.
Lombard, Illinois 60148-3926
(630) 620-5700 Fax (630) 620-8222
www.villageoflombard.org

August 21, 2018

Mr. John Erl
127 S. Chase Lane
Lombard, IL 60148

Village President
Keith T. Giagnorio

Village Clerk
Sharon Kuderna

Trustees
Dan Whittington, Dist. 1
Michael A. Fugiel, Dist. 2
Reid Foltyniewicz, Dist. 3
Bill T. Johnston, Dist. 4
Robyn Pike, Dist. 5
William "Bill" Ware, Dist. 6

Village Manager
Scott R. Niehaus

"Our shared Vision for Lombard is a community of excellence exemplified by its government working together with residents and businesses to create a distinctive sense of spirit and an outstanding quality of life."

"The Mission of the Village of Lombard is to provide superior and responsive governmental services to the people of Lombard."

RE: Private Property Drainage Options for 100 blocks of S. Chase/Highland

Dear Mr. Erl:

This letter shall serve to provide an overview of actions taken to date relative to the private property drainage improvements to serve the 100 blocks of South Chase and Highland. The Village completed the storm sewer improvements on Maple Street in the fall of 2017. Since that time, Village staff has conducted several meetings with you and other property owners within the proposed project area. The Village staff developed and presented options for the private improvements to assist with draining the rear yards in the referenced area, which were included in a May 12, 2017 correspondence (attached).

To date, staff has provided information to you relative to the need for drainage easements to be secured on the property or properties where the improvement will be constructed. Per our last conversation of July 11, 2018, the impacted property owners had been unable to secure the necessary easements to advance the project. The Village stands ready to assist you and the surrounding property owners in completing the project. Please let me know if you would like to have a neighborhood meeting to discuss the project and what additional steps are necessary to complete the project.

Should you have any questions please feel free to contact me.

Sincerely,

Carl Goldsmith
Director of Public Works

cc: Trustee Robyn Pike, District #5
Scott Niehaus, Village Manager

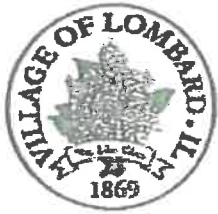

VILLAGE OF LOMBARD

255 E. Wilson Ave.
Lombard, Illinois 60148-3926
(630) 620-5700 Fax (630) 620-8222
www.villageoflombard.org

May 12, 2017

Mr. John Erl
127 S. Chase Lane
Lombard, IL 60148

Village President
Keith T. Giagnorio

Village Clerk
Sharon Kuderna

Trustees
Dan Whittington, Dist. 1
Michael A. Fugiel, Dist. 2
Reid Foltyniewicz, Dist. 3
Bill T. Johnston, Dist. 4
Robyn Pike, Dist. 5
William "Bill" Ware, Dist. 6

Village Manager
Scott R. Niehaus

"Our shared Vision for Lombard is a community of excellence exemplified by its government working together with residents and businesses to create a distinctive sense of spirit and an outstanding quality of life."

"The Mission of the Village of Lombard is to provide superior and responsive governmental services to the people of Lombard."

RE: Private Property Drainage Options for 100 blocks of S. Chase/Highland

Dear Mr. Erl:

Following the meeting of April 6, 2017 conducted with the residents in the 100 blocks of S. Chase and S. Highland, Village staff has developed options for the private improvements to assist with draining the rear yards in the referenced area. These options were developed as conceptual plans and will need further planning and design efforts. As discussed at the meeting, these improvements would be undertaken by the residents and may be eligible for financial assistance from the Village through the Backyard Drainage Grant Program. I have attached a copy of the Grant Application for your consideration.

As discussed and articulated in the final plans for the Gatz Pond Outfall Project, the Village will allow the residents to connect a private storm drain to a forthcoming Village catch basin (Structure 105A) that will be located within the public right-of-way adjacent to 750 E. Maple Street. The connection to the rear yards, and all subsequent improvements on private property, for the referenced properties will be at the discretion of the property owners. Based upon plats available to the Village, there are no easements recorded that would grant rights to install a storm drain through the Maple Street properties. The Village would encourage that formal easements be obtained as necessary to ensure that the residents have legal rights for constructing and maintaining the drainage improvement(s). At a minimum for the purpose of the grant approval and Village building permit, written and notarized permission must be obtained from each effected property owner.

The following options have been developed for the area. The Village has included graphical depictions of each option. These depictions do not provide pipe elevation or material details, but are used for illustrative purposes only. The four (4) options presented by the Village are not inclusive of the methods to address the neighborhood concerns and the residents are free to explore other approaches.

Option #1 -- Drain extending to low point of rear yards between 129 and 125 S. Chase and 134 and 138 S. Highland

- Approximately 250' of 8" PVC or HDPE either under the driveway of 750 E. Maple or 280' through side yards of 750 and 754 E. Maple connecting to the forthcoming catch basin (Structure 105A) in the parkway
- Single 12" x 12" catch basin set in a low point in the basin

Option #2 – Drain extending along centerline of yards up to 109 S. Chase/118 S. Highland

- Approximately 475' of 8" PVC or HDPE through side yards of 750 and 754 E. Maple connecting to forthcoming catch basin (Structure 105A) in parkway. *Actual length of pipe will depend on path selected by residents.*
- Multiple 12" x 12" inlets along center drain

Option #3 - Drain extending along centerline of yards with laterals toward houses to further dewater the soil

- Approximately 475' of 8" PVC or HDPE through side yards of 750 and 754 E. Maple connecting to forthcoming catch basin (Structure 105A) in parkway
- Approximately 450' of 4" perforated PVC or HDPE to serve each property
- Multiple 12" x 12" catch basins along centerline of drain and at the end of each lateral

Option #4 - Drain extending to low point of rear yards between 129 and 125 S. Chase and 134 and 138 S. Highland with properties regraded to direct water to the low point

- Approximately 250' of 8" PVC or HDPE through side yards of 750 and 754 E. Maple connecting to Structure 105A in ROW
- 12" x 12" inlets at end of pipe and at each change in direction
- Fill and grade as needed to address low lying areas, ideally keeping below 1 acre (43,560 SF) of total area of disturbance for the overall project to avoid the need to also obtain a permit from the Illinois Environmental Protection Agency

It is anticipated that each of these options will drain the low lying areas in the rear yards without the need for any mechanical systems to pump down the water. Based upon elevations and capacity, the area may continue to have localized ponding in the low lying areas.

Should you have any questions relative to these options of the forthcoming Gatz Pond Outfall Project, please feel free to contact me. Additional details about the project will be discussed at the neighborhood meeting scheduled for May 25, 2017. Adjacent property owners will receive a separate notice of the meeting in the near future.

Sincerely,

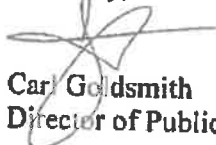

Carl Goldsmith
Director of Public Works

Enclosures: Site Plans for Options 1-4
 Backyard Drainage Grant Application

cc: Trustee Robyn Pike, District #5
 Scott Niehaus, Village Manager
 David Gorman, Assistant Director of Public Works
 Sean Kelly, Village Engineer
 Jana Bryant, Private Development Engineer

Option #1
Village of Lombard - Public Works



May 10, 2017

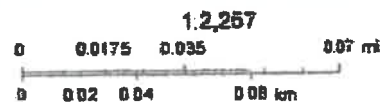

Source: Earl, FHE, Delmar, Hawaii, Hawaii, P. O. Box, 6880
USGS, P.O. Box, 6880, Hawaii, Hawaii, P. O. Box, 6880
Earl, Hawaii, P.O. Box, 6880, Hawaii, Hawaii, P. O. Box, 6880
Oahu, Hawaii, P.O. Box, 6880, Hawaii, Hawaii, P. O. Box, 6880
Hawaii, P.O. Box, 6880, Hawaii, Hawaii, P. O. Box, 6880

An aerial photograph of a residential neighborhood, likely in a city. The image shows a grid of streets and numerous houses. A prominent red line is drawn vertically across the middle of the image, starting from the top and ending near the bottom. At the bottom of this red line, there are several red dots. The houses are mostly dark-colored, and the streets are light-colored. The overall image has a grainy, high-contrast appearance, typical of an aerial photograph.

Source: Sri Lanka, Defense Ministry, Government P Corp. G5000
1985 PRO MPS African Goshima Co. KASSERNAI Oronaka Bay;
Sri Lanka MET, Sri Lanka : -ong Wang 1985000 1985000 1985000
Oronaka Bay 1985000 1985000 1985000 1985000 1985000
1985000

Foreign Country of Dispute: Ontario, Canada and Province of Ontario, Canada. EMBRYO GENETIC TESTING PARAGRAPH 1555 USA, USA:

Option #3
Village of Lombard - Public Works



May 10, 2017

1:2,257

Source: FBI memo, DeWitt Martin, Assistant P. Corp. GEDCO
LESS FRD KPS ASIAN GEDCO; 124 KENNEDY BL. Canton St. N.Y.
Bklyn. 10014. TEL: Bklyn. 466-1000. Business 1200; res. 6
Operating/production: 2nd Fl. G.S. East Company
Production

Research | Council of Dads | www.councilofdads.org | 1-800-421-4211 | 10000 E. 15th Ave. Suite 1000 Denver, CO 80202

Figure 1 is a scale bar with two units of measurement. The top scale is in miles, ranging from 0 to 0.07 with major ticks every 0.01 miles. The bottom scale is in kilometers, ranging from 0 to 0.08 with major ticks every 0.02 kilometers. A specific distance of 12,257 is marked on the top scale, corresponding to approximately 0.035 miles and 0.056 kilometers.

Sources: ERI, ERE, Defense Planning Research & Corp. GEB CO
USGS FAD NPS AFDNA Geobase GEN Kastenholz Occurrence Survey
ERI Japn METL ERI China Pong Hong Kristoforo Vapor-June C
Open-Ended Construction, and the GIS User Community
Purpos



VILLAGE OF LOMBARD

VILLAGE BOARD POLICY MEMORANDUM

**Subject: Backyard Drainage
Program**

**Section: 4.D.
Dept.: PW/CD
Date: January 20, 2000
Updated: November 18, 2010**

I. Purpose

The purpose of this program is to eliminate flood-prone backyards through cooperative efforts by the Village of Lombard and effected residents.

II. Procedures/Guidelines

A. Interested homeowners who can demonstrate that two or more contiguous properties are directly affected by backyard flooding can apply for a grant to provide financial assistance to install a backyard drainage system. "Directly effected" means that the property is subject to standing water for more than 72 hours.

B. Eligible costs may include surveying, engineering, permits, and construction work including connection to public storm sewer and street restoration.

C. Homeowner groups initiate projects and perform surveying and prepare engineering plans by a Professional Engineer. Plans are submitted to Community Development Department for approval.

D. Approved plans are eligible for a grant. Grant applications are submitted to Public Works along with approved plans, cost estimates or bids. Public Works shall evaluate the reasonableness and appropriateness of the grant application. Costs associated with preparing unapproved plans are not eligible for grant funds.

E. Drainage systems must include an appropriate restrictor.

F. Upon successful completion of the work and final inspection, the Village will reimburse the homeowner group for 50% of the project costs up to a maximum of \$5,000.

G. The annual Village contribution to this program will be determined in the Capital Improvement Program.

H. "Direct" or "indirect" connections to combined and sanitary sewer systems are prohibited by current Village ordinance and will not be considered. "Indirect" connections enter a storm sewer that discharges to a combined sewer (recombining).

I. Proposed backyard pumping systems discharging to combined sewer areas that comply with current Village ordinance 50.027 (D) are also eligible for this program (Exhibit "A" attached).

J. Improvements constructed on private property will be operated and maintained by the owners, not the Village of Lombard.

K. The effective date of this policy is December 1, 1999.

III. Legislation/Documentation

A. Minutes of January 11, 2000 Public Works Committee meeting.

B. Minutes of January 20, 2000 Board of Trustees meeting

EXHIBIT "A"

§ 50.027 SUMP PUMP, DOWNSPOUT AND OTHER STORMWATER DISCHARGES

(A) For all habitable structures and business structures constructed after January 1, 1986, all building subsoil drain sump pump discharge pipes shall be connected to the storm sewer system wherever there is a storm sewer reasonably available for such connection as determined by the Director of Public Works.

(B) For all habitable structures and business structures constructed after September 1, 1996, if storm sewers are not reasonably available, all subsoil drain sump discharge pipes shall discharge on a grassed area at any point within fifteen (15) feet of the building structure, away from adjacent properties, and in a manner so as to not cause a nuisance in the public right-of-way, or at the discretion of the Director of Community Development.

(C) Notwithstanding the requirements of 50.26(A) and (B), for all habitable structures and business structures, all downspouts shall be directed away from adjacent properties. Downspouts discharging toward a combined sewer shall discharge onto splash blocks into a grassed area at any point within fifteen (15) feet of the building structure or at the discretion of the Director of Community Development.

(D) Notwithstanding the requirements of 50.026, any person, but only one person from the area tributary to the common depressional storage area, may pump stormwater runoff from a common depressional storage area on private property toward a combined sewer subject to the following restrictions: (1) pumping may not commence or continue during a rainfall event; (2) pumping may not commence until seventy-two (72) hours after a rainfall event or until the Lombard Combined Sewage Treatment Facility has stopped discharging effluent to the East Branch of the DuPage River, whichever is longer; (3) the discharge point must be within fifteen (15) feet of the building structure, and in a manner so as to not cause a nuisance in the public right-of-way, or at the discretion of the Director of Public Works; and (4) no pumping rate can exceed 250 gallons per minute. Notwithstanding the foregoing, pumping as described in this subsection (D) will be prohibited if combined sewer surcharges are induced from such pumping. In addition, the Village of Lombard reserves the right to further restrict the approved pumping rate in individual situations where it has been determined that the maximum rate will result in surcharging, sewer overflows, adverse health or environmental problems.

(70 Code, § 13.08.075) (Ord. 2797, passed 11-14-85, Ord. 4190, passed 7/18/96)

BACKYARD DRAINAGE GRANT PROGRAM
VILLAGE OF LOMBARD, ILLINOIS Board of Trustees POLICY MEMORANDUM 00-1
Application Form (Last revised 3/2/00)

Part 1 -- PROJECT SPONSORS

Date: ____/____/____

By signing, the sponsor and co-sponsors certify, under penalty of law for misrepresentation, that the attached documentation demonstrates that their property is subjected to at least 72 hours of standing water.

Sponsor: _____ Phone: (day) _____ (evening) _____
Address: _____ Lombard, IL 60148 Signature: _____

Co-sponsors agree that sponsor is duly authorized to communicate with the Village on their behalf.

Co-Sponsor: _____ Street Address: _____
Signature: _____

Co-Sponsor: _____ Street Address: _____
Signature: _____

Co-Sponsor: _____ Street Address: _____
Signature: _____

Co-Sponsor: _____ Street Address: _____
Signature: _____

Co-Sponsor: _____ Street Address: _____
Signature: _____

Co-Sponsor: _____ Street Address: _____
Signature: _____

Co-Sponsor: _____ Street Address: _____
Signature: _____

Co-Sponsor: _____ Street Address: _____
Signature: _____

Co-Sponsor: _____ Street Address: _____
Signature: _____

Co-Sponsor: _____ Street Address: _____
Signature: _____

Co-Sponsor: _____ Street Address: _____
Signature: _____

Co-Sponsor: _____ Street Address: _____
Signature: _____

Co-Sponsor: _____ Street Address: _____
Signature: _____

Co-Sponsor: _____ Street Address: _____
Signature: _____

Co-Sponsor: _____ Street Address: _____
Signature: _____

Co-Sponsor: _____ Street Address: _____
Signature: _____

Co-Sponsor: _____ Street Address: _____
Signature: _____

Co-Sponsor: _____ Street Address: _____
Signature: _____

Co-Sponsor: _____ Street Address: _____
Signature: _____

Co-Sponsor: _____ Street Address: _____
Signature: _____

Co-Sponsor: _____ Street Address: _____
Signature: _____

Co-Sponsor: _____ Street Address: _____
Signature: _____

Co-Sponsor: _____ Street Address: _____
Signature: _____

Co-Sponsor: _____ Street Address: _____
Signature: _____

Co-Sponsor: _____ Street Address: _____
Signature: _____

Co-Sponsor: _____ Street Address: _____
Signature: _____

Co-Sponsor: _____ Street Address: _____
Signature: _____

Co-Sponsor: _____ Street Address: _____
Signature: _____

Co-Sponsor: _____ Street Address: _____
Signature: _____

Co-Sponsor: _____ Street Address: _____
Signature: _____

Co-Sponsor: _____ Street Address: _____
Signature: _____

Co-Sponsor: _____ Street Address: _____
Signature: _____

Co-Sponsor: _____ Street Address: _____
Signature: _____

Co-Sponsor: _____ Street Address: _____
Signature: _____

Co-Sponsor: _____ Street Address: _____
Signature: _____

Co-Sponsor: _____ Street Address: _____
Signature: _____

Co-Sponsor: _____ Street Address: _____
Signature: _____

Co-Sponsor: _____ Street Address: _____
Signature: _____

Co-Sponsor: _____ Street Address: _____
Signature: _____

Co-Sponsor: _____ Street Address: _____
Signature: _____

Co-Sponsor: _____ Street Address: _____
Signature: _____

Co-Sponsor: _____ Street Address: _____
Signature: _____

Co-Sponsor: _____ Street Address: _____
Signature: _____

Co-Sponsor: _____ Street Address: _____
Signature: _____

Co-Sponsor: _____ Street Address: _____
Signature: _____

Co-Sponsor: _____ Street Address: _____
Signature: _____

Co-Sponsor: _____ Street Address: _____
Signature: _____

Co-Sponsor: _____ Street Address: _____
Signature: _____

Co-Sponsor: _____ Street Address: _____
Signature: _____

Co-Sponsor: _____ Street Address: _____
Signature: _____

Co-Sponsor: _____ Street Address: _____
Signature: _____

Co-Sponsor: _____ Street Address: _____
Signature: _____

Co-Sponsor: _____ Street Address: _____
Signature: _____

Co-Sponsor: _____ Street Address: _____
Signature: _____

Co-Sponsor: _____ Street Address: _____
Signature: _____

Co-Sponsor: _____ Street Address: _____
Signature: _____

Co-Sponsor: _____ Street Address: _____
Signature: _____

Co-Sponsor: _____ Street Address: _____
Signature: _____

Co-Sponsor: _____ Street Address: _____
Signature: _____

Co-Sponsor: _____ Street Address: _____
Signature: _____

Part 2 -- EVIDENCE OF STANDING WATER FOR 72 HOURS AFFECTING 2 OR MORE PROPERTIES

How often does the property collect water that remains for at least 72 hours? _____

How many properties are effected? _____

How many years has it flooded? _____

Please attach photos, statements, inspections, or any other evidence that this property has experienced backyard drainage problems resulting in standing water for 72 hours affecting at least 2 properties. The Village of Lombard may require that a property inspection be performed prior to grant approval.

The included information is true to the best of our knowledge: _____

Signature of Sponsor _____

Part 3 -- PLAN APPROVAL Attach approved plan from Community Development Department.

Signature of Community Development Official _____

Print Name _____

Date ____/____/____

Part 4 -- COST ESTIMATE Attach contractor's proposal. We suggest at least two (2) estimates be obtained. The cost estimate for the proposed work is \$ _____

Part 5 -- GRANT APPROVAL Approved for 50% of system costs not to exceed \$5,000.

Signature of Public Works Official _____

Print Name _____

Date ____/____/____

Part 6 -- PERMITS For pumping systems: Plumbing permit and electrical permit has been issued by Bureau of Inspectional Services and fees paid. Attach documentation.

Bureau of Inspectional Services (BIS) _____

Print Name _____

Date ____/____/____

Part 7 -- CERTIFICATION OF FINAL INSPECTION

Bureau of Inspectional Services (BIS) _____

Print Name _____

Date of Final Inspection ____/____/____

Community Development Department _____

Print Name _____

Date of Final Inspection ____/____/____

Part 8 -- PROJECT COMPLETE: REQUEST FOR REIMBURSEMENT Drainage work is finished to our complete satisfaction; contractors are paid in-full; and we are requesting reimbursement for the approved grant amount. Final project cost was \$ _____. Attach documentation & complete reverse side.

Signature of Sponsor _____

Print Name _____

Date ____/____/____

Part 9 -- AUTHORIZATION FOR REIMBURSEMENT Approved for reimbursement in the amount of \$ _____ for backyard drainage work performed in accordance with Board of Trustees Policy Memorandum 00-1.

Signature of Public Works Official _____

Print Name _____

Date ____/____/____

REIMBURSEMENT AGREEMENT

Date: ____/____/____

To: Public Works Department

From: Backyard Drainage Project Sponsor and Co-sponsors

Subject: Agreed reimbursement amounts

We agree to the following distribution of reimbursement amounts for project costs:

Please print CLEARLY:

Sponsor _____	\$ _____ or _____%	Signature _____
Address _____ Lombard, IL 60148		

Co-Sponsor _____	\$ _____ or _____%	Signature _____
Address _____ Lombard, IL 60148		

Co-Sponsor _____	\$ _____ or _____%	Signature _____
Address _____ Lombard, IL 60148		

Co-Sponsor _____	\$ _____ or _____%	Signature _____
Address _____ Lombard, IL 60148		

Co-Sponsor _____	\$ _____ or _____%	Signature _____
Address _____ Lombard, IL 60148		

Co-Sponsor _____	\$ _____ or _____%	Signature _____
Address _____ Lombard, IL 60148		

REIMBURSEMENT PAYMENT APPROVAL

For Village staff use:

Acct# 7901.756420 Proj # 5517

Approved: _____	_____/_____/_____ Date
Director of Public Works	

Approved: _____	_____/_____/_____ Date
Finance Director	

Approved: _____	_____/_____/_____ Date
Village Manager	



VILLAGE OF LOMBARD

255 E. Wilson Ave.
Lombard, Illinois 60148-3926
(630) 620-5700 Fax (630) 620-8222
www.villageoflombard.org

May 12, 2017

Village President
Keith T. Giagnorio

Village Clerk
Sharon Kuderna

Trustees
Dan Whittington, Dist. 1
Michael A. Fugiel, Dist. 2
Reid Foltyniewicz, Dist. 3
Bill T. Johnston, Dist. 4
Robyn Pike, Dist. 5
William "Bill" Ware, Dist. 6

Village Manager
Scott R. Niehaus

"Our shared Vision for Lombard is a community of excellence exemplified by its government working together with residents and businesses to create a distinctive sense of spirit and an outstanding quality of life."

"The Mission of the Village of Lombard is to provide superior and responsive governmental services to the people of Lombard."

Mr. John Erl
127 S. Chase Lane
Lombard, IL 60148

RE: Private Property Drainage Options for 100 blocks of S. Chase/Highland

Dear Mr. Erl:

Following the meeting of April 6, 2017 conducted with the residents in the 100 blocks of S. Chase and S. Highland, Village staff has developed options for the private improvements to assist with draining the rear yards in the referenced area. These options were developed as conceptual plans and will need further planning and design efforts. As discussed at the meeting, these improvements would be undertaken by the residents and may be eligible for financial assistance from the Village through the Backyard Drainage Grant Program. I have attached a copy of the Grant Application for your consideration.

As discussed and articulated in the final plans for the Gatz Pond Outfall Project, the Village will allow the residents to connect a private storm drain to a forthcoming Village catch basin (Structure 105A) that will be located within the public right-of-way adjacent to 750 E. Maple Street. The connection to the rear yards, and all subsequent improvements on private property, for the referenced properties will be at the discretion of the property owners. Based upon plats available to the Village, there are no easements recorded that would grant rights to install a storm drain through the Maple Street properties. The Village would encourage that formal easements be obtained as necessary to ensure that the residents have legal rights for constructing and maintaining the drainage improvement(s). At a minimum for the purpose of the grant approval and Village building permit, written and notarized permission must be obtained from each effected property owner.

The following options have been developed for the area. The Village has included graphical depictions of each option. These depictions do not provide pipe elevation or material details, but are used for illustrative purposes only. The four (4) options presented by the Village are not inclusive of the methods to address the neighborhood concerns and the residents are free to explore other approaches.

Option #1 – Drain extending to low point of rear yards between 129 and 125 S. Chase and 134 and 138 S. Highland

- Approximately 250' of 8" PVC or HDPE either under the driveway of 750 E. Maple or 280' through side yards of 750 and 754 E. Maple connecting to the forthcoming catch basin (Structure 105A) in the parkway
- Single 12" x 12" catch basin set in a low point in the basin

Option #2 – Drain extending along centerline of yards up to 109 S. Chase/118 S. Highland

- Approximately 475' of 8" PVC or HDPE through side yards of 750 and 754 E. Maple connecting to forthcoming catch basin (Structure 105A) in parkway. *Actual length of pipe will depend on path selected by residents.*
- Multiple 12" x 12" inlets along center drain

Option #3 - Drain extending along centerline of yards with laterals toward houses to further dewater the soil

- Approximately 475' of 8" PVC or HDPE through side yards of 750 and 754 E. Maple connecting to forthcoming catch basin (Structure 105A) in parkway
- Approximately 450' of 4" perforated PVC or HDPE to serve each property
- Multiple 12" x 12" catch basins along centerline of drain and at the end of each lateral

Option #4 - Drain extending to low point of rear yards between 129 and 125 S. Chase and 134 and 138 S. Highland with properties regraded to direct water to the low point

- Approximately 250' of 8" PVC or HDPE through side yards of 750 and 754 E. Maple connecting to Structure 105A in ROW
- 12" x 12" inlets at end of pipe and at each change in direction
- Fill and grade as needed to address low lying areas, ideally keeping below 1 acre (43,560 SF) of total area of disturbance for the overall project to avoid the need to also obtain a permit from the Illinois Environmental Protection Agency

It is anticipated that each of these options will drain the low lying areas in the rear yards without the need for any mechanical systems to pump down the water. Based upon elevations and capacity, the area may continue to have localized ponding in the low lying areas.

Should you have any questions relative to these options of the forthcoming Gatz Pond Outfall Project, please feel free to contact me. Additional details about the project will be discussed at the neighborhood meeting scheduled for May 25, 2017. Adjacent property owners will receive a separate notice of the meeting in the near future.

Sincerely,

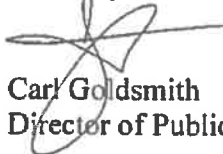

Carl Goldsmith
Director of Public Works

Enclosures: Site Plans for Options 1-4
 Backyard Drainage Grant Application

cc: Trustee Robyn Pike, District #5
 Scott Niehaus, Village Manager
 David Gorman, Assistant Director of Public Works
 Sean Kelly, Village Engineer
 Jana Bryant, Private Development Engineer

Option #1 Village of Lombard - Public Works



May 10, 2017

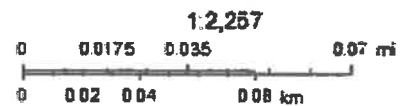

Sources: Esri, HERE, DeLorme, Intermap, increment P Corp., GEBCO, USGS, FAO, NPS, NRCAN, GeBCO, IGN, Kadaster NL, Ordnance Survey, Esri Japan, METI, Esri China (Hong Kong), Swisstopo, UTM, and others. © OverSeasMap.com, and the GIS User Community.

Option #2 Village of Lombard - Public Works



May 10, 2017

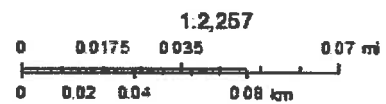

Sources: Esri HERE, DeLorme, Intermap, increment P Corp., GEBCO, USGS, FAO, NPS, NRCAN, GEBCO, IGN, Kartchner, Ordnance Survey, Esri Japan, METI, Esri China (Hong Kong), Swisstopo, UTM, and © OpenStreetMap contributors, and the GIS User Community

Processed by County of DuPage, Chicago Base Map, Property of Chicago, Esri HERE, DeLorme, increment P Corp., USGS, FAO, NPS, NRCAN, GEBCO, IGN, Kartchner, Ordnance Survey, Esri Japan, METI, Esri China (Hong Kong), Swisstopo, UTM, and © OpenStreetMap contributors, and the GIS User Community

Option #3 Village of Lombard - Public Works



May 10, 2017

1:2,257
0 0.0175 0.035 0.07 mi
0 0.02 0.04 0.08 km

Sources: Esri, HERE, DeLorme, Intermap, increment P Corp., GEBCO, USGS, FAO, NPS, NRCAN, GeBCO, IGN, swisstopo, Aerial, Swire, Esri Japan, METI, Esri China (Hong Kong), Swisstopo, Aerial, IGN, Esri OpenStreetMap contributors, and the GIS User Community

Prepared by: County of DuPage, Office of the County Clerk, Esri, HERE, Garmin, INCREMENT P, Intermap, USGS, Esri, USDA

Option #4 Village of Lombard - Public Works

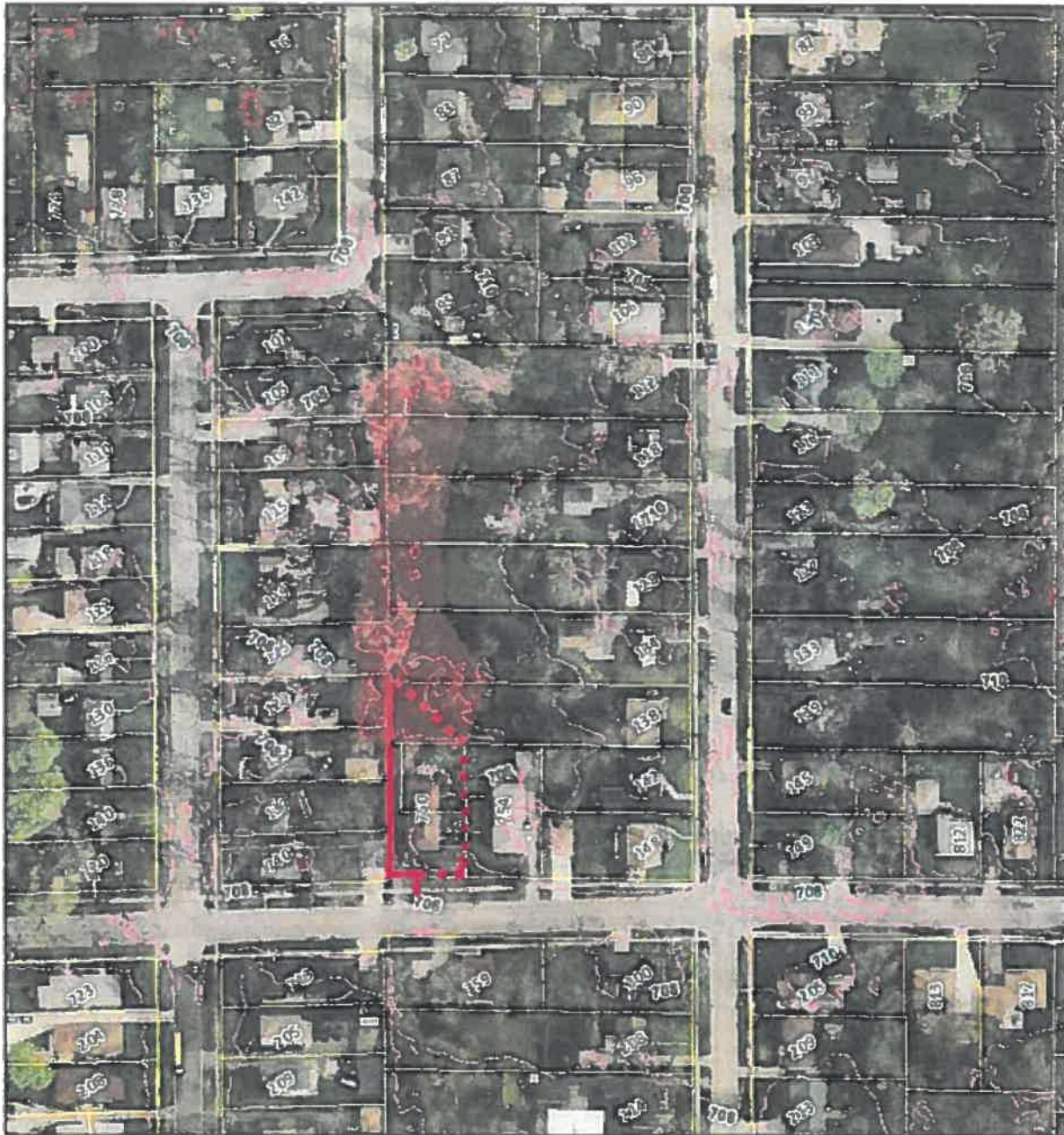

May 10, 2017

1:2,257
0 00175 0035 007 mi
0 0.02 0.04 0.08 km

Sources: Esri, HERE, DeLorme, Intermap, increment P Corp., GEBCO, USGS, FAO, NPS, NRCAN, GeBCO, IGN, Kadaster NL, Ordnance Survey, Esri Japan, METI, Esri China (Hong Kong), Swisstopo, Mapbox, © OpenStreetMap contributors, and the GIS User Community

Permitted County of DuPage, Ontario, and Province of Ontario, Esri, HERE, Garmin, INCREMENT P, Intermap, USGS, EPA, USDA,



VILLAGE OF LOMBARD

VILLAGE BOARD POLICY MEMORANDUM

**Subject: Backyard Drainage
Program**

**Section: 4.D.
Dept.: PW/CD
Date: January 20, 2000
Updated: November 18, 2010**

I. Purpose

The purpose of this program is to eliminate flood-prone backyards through cooperative efforts by the Village of Lombard and effected residents.

II. Procedures/Guidelines

A. Interested homeowners who can demonstrate that two or more contiguous properties are directly affected by backyard flooding can apply for a grant to provide financial assistance to install a backyard drainage system. "Directly effected" means that the property is subject to standing water for more than 72 hours.

B. Eligible costs may include surveying, engineering, permits, and construction work including connection to public storm sewer and street restoration.

C. Homeowner groups initiate projects and perform surveying and prepare engineering plans by a Professional Engineer. Plans are submitted to Community Development Department for approval.

D. Approved plans are eligible for a grant. Grant applications are submitted to Public Works along with approved plans, cost estimates or bids. Public Works shall evaluate the reasonableness and appropriateness of the grant application. Costs associated with preparing unapproved plans are not eligible for grant funds.

E. Drainage systems must include an appropriate restrictor.

F. Upon successful completion of the work and final inspection, the Village will reimburse the homeowner group for 50% of the project costs up to a maximum of \$5,000.

G. The annual Village contribution to this program will be determined in the Capital Improvement Program.

H. "Direct" or "indirect" connections to combined and sanitary sewer systems are prohibited by current Village ordinance and will not be considered. "Indirect" connections enter a storm sewer that discharges to a combined sewer (recombining).

I. Proposed backyard pumping systems discharging to combined sewer areas that comply with current Village ordinance 50.027 (D) are also eligible for this program (Exhibit "A" attached).

J. Improvements constructed on private property will be operated and maintained by the owners, not the Village of Lombard.

K. The effective date of this policy is December 1, 1999.

III. Legislation/Documentation

A. Minutes of January 11, 2000 Public Works Committee meeting.

B. Minutes of January 20, 2000 Board of Trustees meeting

EXHIBIT "A"

§ 50.027 SUMP PUMP, DOWNSPOUT AND OTHER STORMWATER DISCHARGES

(A) For all habitable structures and business structures constructed after January 1, 1986, all building subsoil drain sump pump discharge pipes shall be connected to the storm sewer system wherever there is a storm sewer reasonably available for such connection as determined by the Director of Public Works.

(B) For all habitable structures and business structures constructed after September 1, 1996, if storm sewers are not reasonably available, all subsoil drain sump discharge pipes shall discharge on a grassed area at any point within fifteen (15) feet of the building structure, away from adjacent properties, and in a manner so as to not cause a nuisance in the public right-of-way, or at the discretion of the Director of Community Development.

(C) Notwithstanding the requirements of 50.26(A) and (B), for all habitable structures and business structures, all downspouts shall be directed away from adjacent properties. Downspouts discharging toward a combined sewer shall discharge onto splash blocks into a grassed area at any point within fifteen (15) feet of the building structure or at the discretion of the Director of Community Development.

(D) Notwithstanding the requirements of 50.026, any person, but only one person from the area tributary to the common depressional storage area, may pump stormwater runoff from a common depressional storage area on private property toward a combined sewer subject to the following restrictions: (1) pumping may not commence or continue during a rainfall event; (2) pumping may not commence until seventy-two (72) hours after a rainfall event or until the Lombard Combined Sewage Treatment Facility has stopped discharging effluent to the East Branch of the DuPage River, whichever is longer; (3) the discharge point must be within fifteen (15) feet of the building structure, and in a manner so as to not cause a nuisance in the public right-of-way, or at the discretion of the Director of Public Works; and (4) no pumping rate can exceed 250 gallons per minute. Notwithstanding the foregoing, pumping as described in this subsection (D) will be prohibited if combined sewer surcharges are induced from such pumping. In addition, the Village of Lombard reserves the right to further restrict the approved pumping rate in individual situations where it has been determined that the maximum rate will result in surcharging, sewer overflows, adverse health or environmental problems.

('70 Code, § 13.08.075) (Ord. 2797, passed 11-14-85, Ord. 4190, passed 7/18/96)

BACKYARD DRAINAGE GRANT PROGRAM
VILLAGE OF LOMBARD, ILLINOIS Board of Trustees POLICY MEMORANDUM 00-1
Application Form (Last revised 3/2/00)

Part 1 – PROJECT SPONSORS

Date: ____/____/____

By signing, the sponsor and co-sponsors certify, under penalty of law for misrepresentation, that the attached documentation demonstrates that their property is subjected to at least 72 hours of standing water.

Sponsor: _____ Phone: (day) _____ (evening) _____

Address: _____ Lombard, IL 60148 Signature: _____

Co-sponsors agree that sponsor is duly authorized to communicate with the Village on their behalf.

Co-Sponsor: _____ Street Address: _____

Signature: _____

Co-Sponsor: _____ Street Address: _____

Signature: _____

Co-Sponsor: _____ Street Address: _____

Signature: _____

Co-Sponsor: _____ Street Address: _____

Signature: _____

Co-Sponsor: _____ Street Address: _____

Signature: _____

Part 2 – EVIDENCE OF STANDING WATER FOR 72 HOURS AFFECTING 2 OR MORE PROPERTIES

How often does the property collect water that remains for at least 72 hours? _____

How many properties are effected? _____. How many years has it flooded? _____

Please attach photos, statements, inspections, or any other evidence that this property has experienced backyard drainage problems resulting in standing water for 72 hours affecting at least 2 properties. The Village of Lombard may require that a property inspection be performed prior to grant approval.

The included information is true to the best of our knowledge: _____

Signature of Sponsor

Part 3 -- PLAN APPROVAL Attach approved plan from Community Development Department.

Signature of Community Development Official _____

Print Name _____

Date ____/____/____

Part 4 – COST ESTIMATE Attach contractor's proposal. We suggest at least two (2) estimates be obtained. The cost estimate for the proposed work is \$ _____

Part 5 -- GRANT APPROVAL Approved for 50% of system costs not to exceed \$5,000.

Signature of Public Works Official _____

Print Name _____

Date ____/____/____

Part 6 -- PERMITS For pumping systems: Plumbing permit and electrical permit has been issued by Bureau of Inspectional Services and fees paid. *Attach documentation.*

Bureau of Inspectional Services (BIS) _____

Print Name _____

Date ____/____/____

Part 7 -- CERTIFICATION OF FINAL INSPECTION

Bureau of Inspectional Services (BIS) _____

Print Name _____

Date of Final Inspection ____/____/____

Community Development Department _____

Print Name _____

Date of Final Inspection ____/____/____

Part 8 -- PROJECT COMPLETE; REQUEST FOR REIMBURSEMENT Drainage work is finished to our complete satisfaction; contractors are paid in-full; and we are requesting reimbursement for the approved grant amount. Final project cost was \$ _____. *Attach documentation & and complete reverse side.*

Signature of Sponsor _____

Print Name _____

Date ____/____/____

Part 9 -- AUTHORIZATION FOR REIMBURSEMENT Approved for reimbursement in the amount of \$ _____ for backyard drainage work performed in accordance with Board of Trustees Policy Memorandum 00-1.

Signature of Public Works Official _____

Print Name _____

Date ____/____/____

REIMBURSEMENT AGREEMENT

Date: ____/____/____

To: Public Works Department

From: Backyard Drainage Project Sponsor and Co-sponsors

Subject: Agreed reimbursement amounts

We agree to the following distribution of reimbursement amounts for project costs:

Please print CLEARLY:

Sponsor _____	\$ _____ or _____ %	Signature _____
Address _____ Lombard, IL 60148		

Co-Sponsor _____	\$ _____ or _____ %	Signature _____
Address _____ Lombard, IL 60148		
Co-Sponsor _____	\$ _____ or _____ %	Signature _____
Address _____ Lombard, IL 60148		
Co-Sponsor _____	\$ _____ or _____ %	Signature _____
Address _____ Lombard, IL 60148		
Co-Sponsor _____	\$ _____ or _____ %	Signature _____
Address _____ Lombard, IL 60148		
Co-Sponsor _____	\$ _____ or _____ %	Signature _____
Address _____ Lombard, IL 60148		

REIMBURSEMENT PAYMENT APPROVAL

For Village staff use:		<u>Acct# 7901.756420 Proj# 5517</u>
Approved: _____	____/____/____	Date
Director of Public Works		
Approved: _____	____/____/____	Date
Finance Director		
Approved: _____	____/____/____	Date
Village Manager		

Chase/Highland Private Storm Sewer

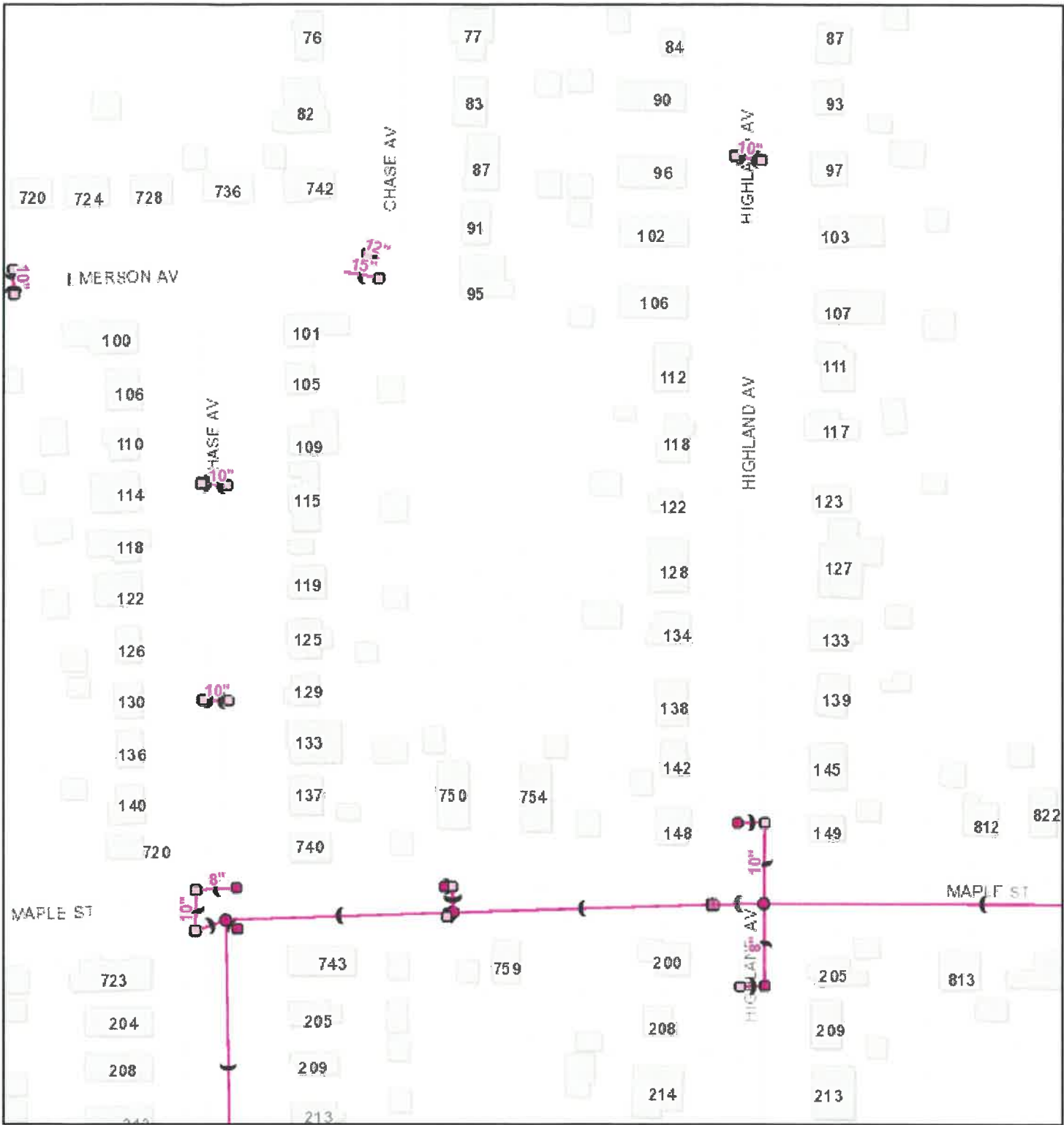

6/13/2018, 9:02:15 AM

1:2,257

- | | | |
|-----------------------------|------------------------|----------------|
| Storm Facilities | Culverts | Storm Manholes |
| Storm Underground Detention | Non-VOL Culverts | Cleanout |
| Storm Casement | Lombard Culverts | Junction Box |
| Storm Pipe | Storm Plugs & Reducers | |
| Non-VOL | Plug | |
| Lombard | Reducer | |

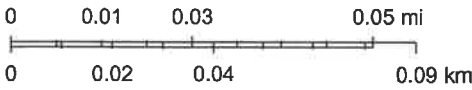

Sources: Esri, HERE, Garmin, Intermap, increment P Corp., GEBCO, USGS, FAO, NPS, NRCAN, GeoBase, IGN, Kadaster NL, Ordnance Survey, Esri Japan, METI, Esri China (Hong Kong), swisstopo, © OpenStreetMap contributors, and the GIS User Community, Village of Lombard, Dennis

Chase/Highland Option #5

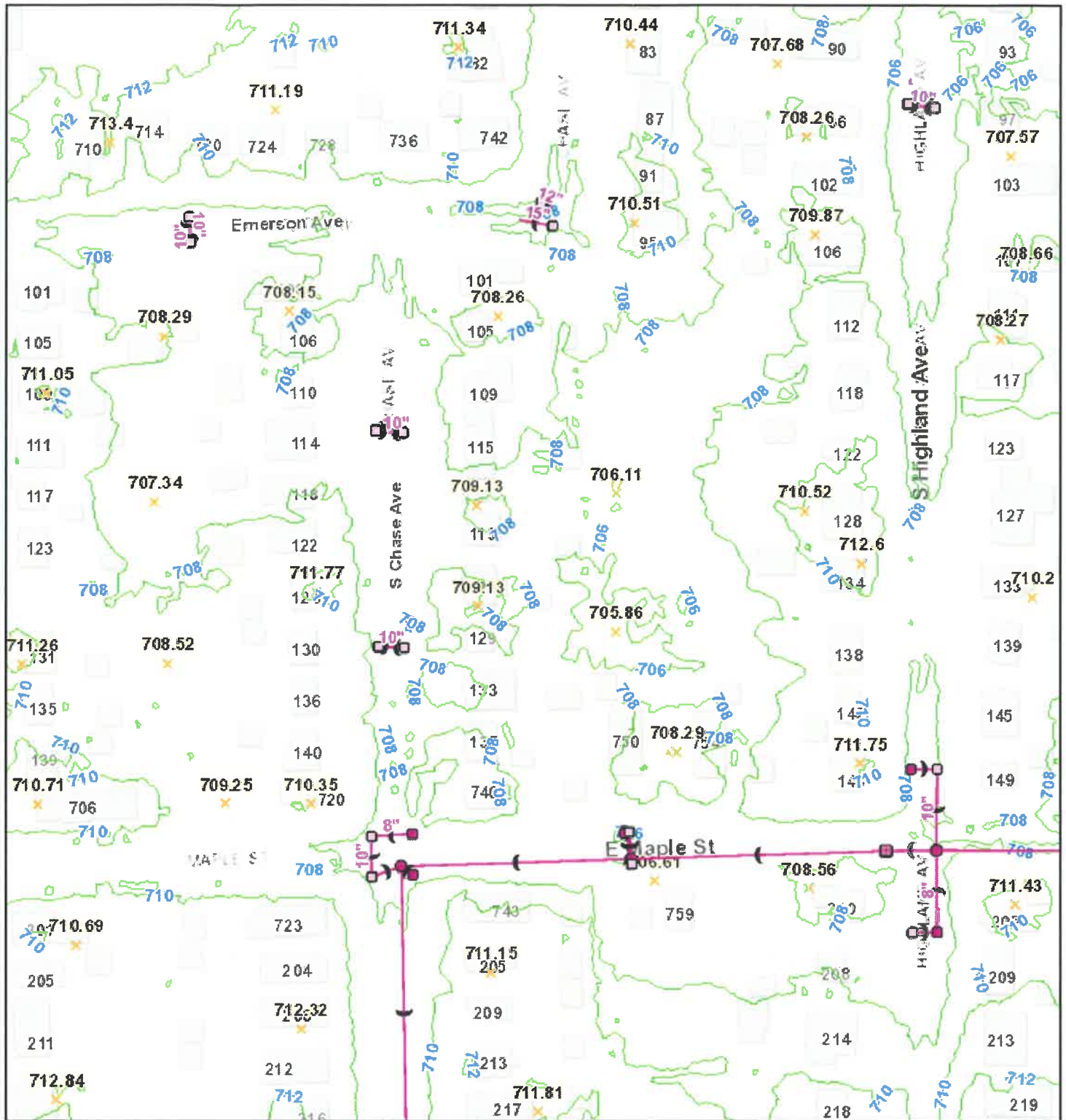

9/6/2018, 8:37:00 AM

1:2,257

- | | | |
|-----------------------------|-----------------------------------|--------------------|
| Storm Facilities | Culverts | Storm Manholes |
| Storm Underground Detention | Non-VOL Culverts | <all other values> |
| Storm Casement | Lombard Culverts | Cleanout |
| Storm Pipe | Storm Plugs & Reducers | Junction Box |
| Non-VOL | Plug | |
| Lombard | Reducer | |

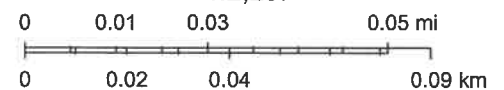

Sources: Esri, HERE, Garmin, Intermap, increment P Corp., GEBCO, USGS, FAO, NPS, NRCAN, GeoBase, IGN, Kadaster NL, Ordnance Survey, Esri Japan, METI, Esri China (Hong Kong), swisstopo, © OpenStreetMap contributors, and the GIS User Community, Village of Lombard, Dennis

Village of Lombard

Department of Public Works

Highland and Maple Drainage

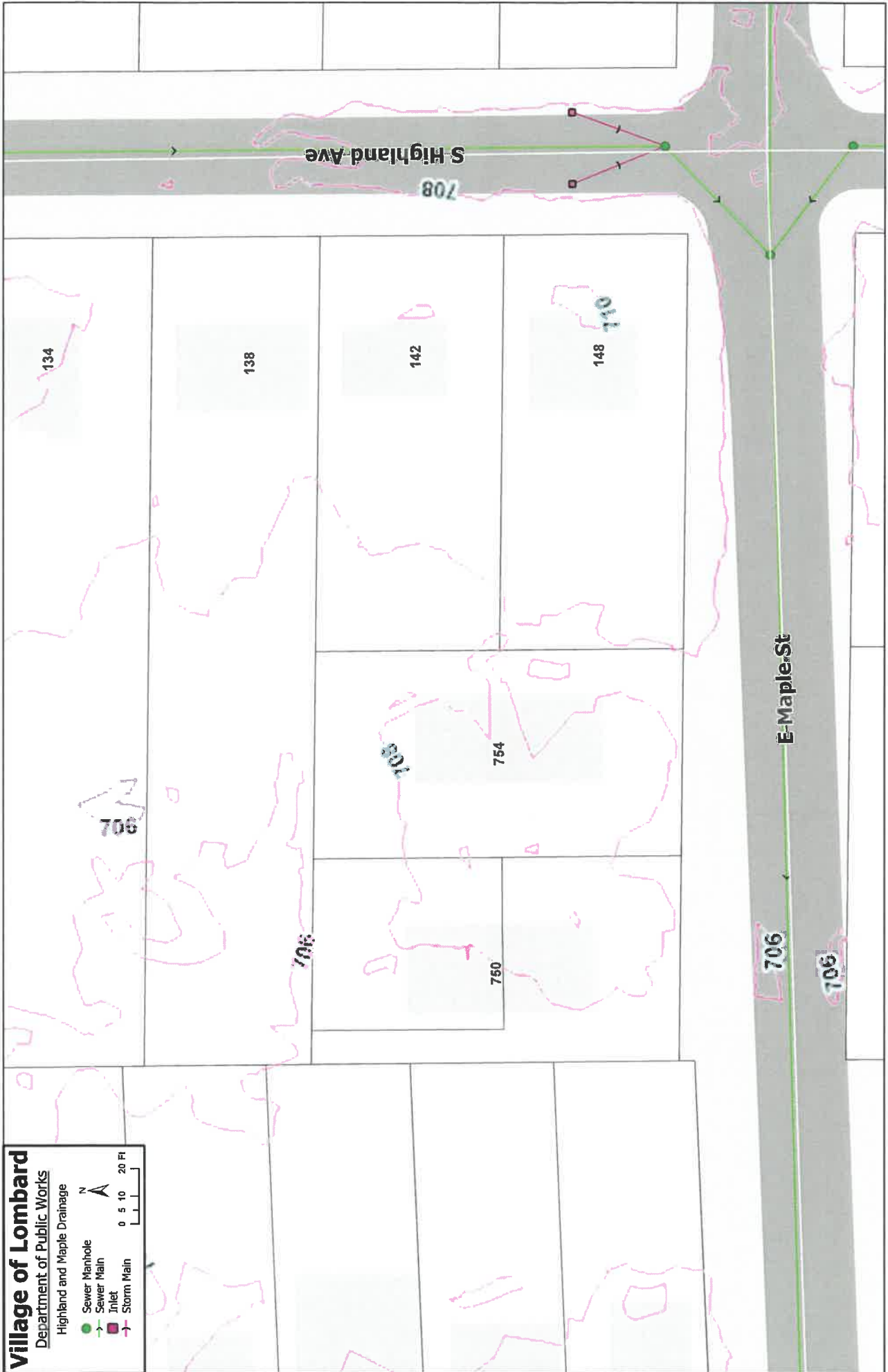
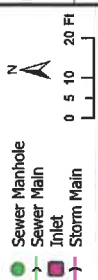

Village of Lombard
Public Works Department
Backyard Drainage Grant Program

10/2/2018

Name	No.	Dir.	Address	Grant Approved	Estimate	Final App Received	Processed in NWS	Amount Reimbursed
Dehner	241	S	Brewster					\$5,000.00
							FY00 Sub Total	\$5,000.00
McManis	429	W	Madison	N/A		7/9/2000	7/13/2000	\$1,900.00
Mahoney-Higgins	422	E	North Broadway	6/5/2000		10/12/2000	10/23/2000	\$4,412.50
							FY01 Sub Total	\$6,312.50
Sunich	316	N	Martha	3/20/2001		6/8/2001	7/13/2001	\$3,707.88
Kaylor	242	S	Edson	8/20/2001		9/10/2001	9/12/2001	\$3,490.07
Turay	1147	E	Division	9/7/2001				
							FY02 Sub Total	\$7,197.95
Chirello	224	N	Martha	4/1/2002		6/26/2002	7/1/2002	\$1,937.75
Adrian Dominican Sisters	1047		Apple	7/12/2002		7/27/2002	7/30/2002	\$2,551.00
Konrath	518	S	Addison	4/16/2002		7/17/2002	7/18/2002	\$1,819.56
W. LeMoynne/Rt64 Group			multiple addresses	8/29/2002		10/7/2002	10/8/2002	\$5,444.19
Crudele	1160	S	Edgewood	6/25/2002		10/8/2002	10/8/2002	\$2,914.00
							FY03 Sub Total	\$14,666.50
White/multi sponsors	439	W	Windsor	10/30/2003		12/8/2003	12/10/2003	\$2,467.50
Comm Presbyterian Church	1111	E	Madison	3/18/2004		5/18/2004	5/20/2004	\$6,169.59
							FY04 Sub Total	\$8,637.09
Steve DeBoer	61	N	Elizabeth	9/21/2004		12/28/2004	12/28/2004	\$2,592.50
							FY05 Sub Total	\$2,592.50

Village of Lombard
Public Works Department
Backyard Drainage Grant Program

10/2/2018

Name	No.	Dir.	Address	Grant Approved	Estimate	Final App Received	Processed in NWS	Amount Reimbursed
							FY06 Sub Total	\$0.00
LoCoco	1033	E	Kenilworth	11/21/2006		1/10/2007	1/17/2007	\$3,087.95
							FY07 Sub Total	\$3,087.95
Clark	18		Lombard Circle	4/24/2007		5/22/2007	5/22/2007	\$2,030.00
							FY07 Sub Total	\$2,030.00
Quirk	554	S	Stewart	7/13/2007		6/26/2007	7/17/2007	\$215.62
Johansson	303	W	Harding	6/14/2007		7/9/2007	8/21/2007	\$3,400.00
*Riley	109	W	Park Drive	10/29/2007		11/27/2007	11/27/2007	\$3,450.00
Gnadt	238	N	Broadview	4/8/2008		5/20/2008	5/27/2008	\$3,258.00
							FY08 Sub Total	\$6,850.00
Romano	101		June Lane	5/23/2008		7/10/2008	7/11/2008	\$3,150.00
*Riley	109	W	Park Drive	See above		addl landscaping	6/16/2008	\$625.00
*Riley	109	W	Park Drive	See above		addl landscaping	8/19/2008	\$1,590.00
Kladiwa	1045	S	Grace	2/21/2008		6/6/2008	6/16/2008	\$5,459.00
							FY09 Sub Total	\$5,365.00
Frano	109	E	Morningside	5/1/2009		8/10/2009	8/14/2009	\$2,450.00
Kecskes	602	E	LeMoyné	6/2/2009		8/4/2009	8/4/2009	\$1,209.31
Dembek	509	S	Lewis	6/12/2009		8/14/2009	8/26/2009	\$1,439.00
Howe	101	E	Ash	6/11/2149		9/11/2009	9/14/2009	\$2,455.00
Friend	45	E	Hickory	6/29/2009		10/20/2009	10/23/2009	\$3,250.00
Leonhardt	25	E	Washington	10/6/2009		11/17/2009	11/18/2009	\$1,100.00
Wendt	362	W	Eugenia	4/27/2010		5/4/2010	5/4/2010	\$2,050.00
							FY10 Sub Total	\$13,953.31
Demko/Kurtz	468/472	S	Park	5/20/2010		11/5/2010	11/15/2010	\$5,077.50
Sosin/Happy Home Builders	720	S	Hammerschmidt	9/20/2010		10/12/2010	10/13/2010	\$3,275.00
O'Brien/Freese	553	S	Martha	9/22/2010		11/4/2010	11/5/2010	\$4,235.00
Gorman/Bohan/Obermeier	211	S	Martha	9/22/2010		11/5/2010	11/9/2010	\$4,503.50

3

Village of Lombard
Public Works Department
Backyard Drainage Grant Program

10/2/2018

Name	No.	Dir.	Address	Grant Approved	Estimate	Final App Received	Processed in NWS	Amount Reimbursed	20k budget
					\$24,675		FY17 Sub Total	\$13,828.87	20k budget
Mager	536 S	S	Edgewood	1/29/2018			5/3/2018	\$3,497.50	
Raymond Petersdorf	1077	S	Cherry Ln	5/16/2018			8/31/2018	\$2,884.25	
Douglas Delaney	1081	S	Cherry Ln				8/31/2018	\$2,009.75	
Stein	710	S	Addison	7/13/2018	\$12,995				
Lois Weaser	43	W	Berkshire	8/17/2018	\$9,990				
Mucha	314	S	Craig	12/15/2017			8/31/2018	\$3,857.50	ADMIN/Se
					\$22,985.00		FY18 Sub Total	\$12,249.00	20k budget